

The logo for Fkservis, featuring the letters 'FK' in red and 'servis' in blue, with a red and blue swoosh underneath. A small red circular icon with a white dot is positioned above the 'i' in 'servis'.

FKservis

A photograph of the Louis Vuitton Foundation in Paris, showing its distinctive curved, glass and metal facade. The building is set against a clear blue sky with some bare trees in the foreground.

Louis Vuitton Foundation - Paris

... even here we were **IN**stalling smoke and heat ventilation systems

A close-up photograph of a fire shutter roller curtain. The curtain is made of a heavy, grey, textured material and is partially rolled up, revealing a black metal grate below. The background is a plain, light-colored wall.

FIRE SHUTTERS

ROLLER CURTAIN

Modern architecture and innovated engineering requires increasingly demanding technologies and technical solutions in the field of fire protection of buildings. In many objects you can meet the requirement of fire separating construction which is in normal situation opened and is not suitable to install here fire shutters as fireproof doors or gates due to architectural or dispositional terms.

Curtain fire roller shutter has been invented due this requirement. As any other fire shutter prevents spread of fire in horizontal direction between fire sections to fulfill strict fire safety requirements.

Types of fire roll shutters:

- **preventing the spread of heat** with fire resistance **E15-120 minutes**
- **limiting the spread of heat** with fire resistance **EW15-120 minutes**

Possibilities of usage:

- any fire shutter in manufacturing or storage buildings, shopping centers, airports, administration buildings, hospitals and many other objects
- fire curtain of theatre
- fire shutter in underground garages and parking houses
- fire shutter on roller conveyors

Fire roll shutter is rolled up in curtain case when no alarm is present. Only in case of fire alarm or during function test curtain goes down to lower position. Fire roll shutter is controlled by control panel with own backup source. Activation is triggered by potential free NC contact of Electronic Fire Signalization system (EFS), smoke or heat detector contact or pushbutton. In terms of montage smoke curtain can be mounted in two ways. In front of building opening or into building opening.

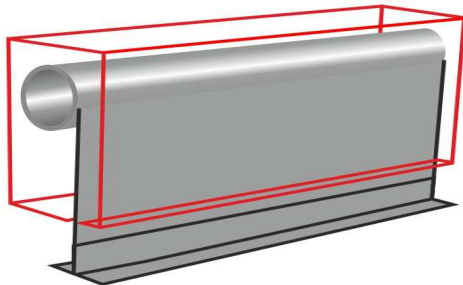

Technical specifications:

- material fiber glass fabric with stainless steel fibers
- weight 660g/m²
- color silver-gray
- area without limitations
- drive 24V DC / 230V AC
- power supply 230V AC
- side guides yes 100(150)x55mm

Fire roll shutter **FKK-ROLL MINI** EW15-30 is installed with purpose to decrease radiant heat intensity emerging due to fire and to prevent spreading of fire through open fire separating construction (window) in direction from or into object. Electric power supply is not necessary. **Fire shutter replaces very expensive window with fire resistance.**

Fire shutter composition:

- case with octagonal shaft
- side guides
- fabric with weight
- metallic heat fuse for self active closing

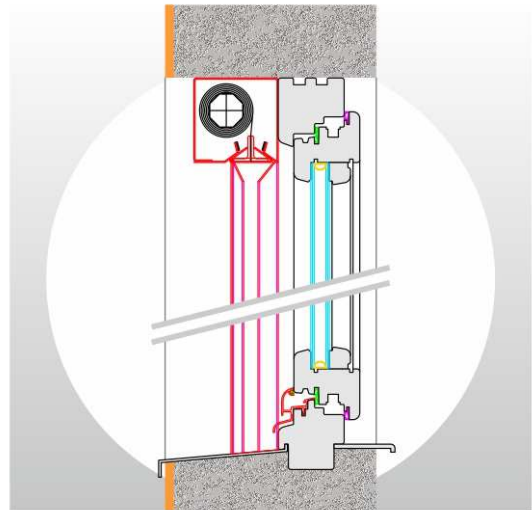

Technical specifications:

- material fiber glass fabric with stainless steel fibers
- weight 660g/m²
- color silver-gray
- area max. 2500x2000mm
- drive no
- power supply no
- side guides yes 60x55mm

On request we will provide you with more accurate technical information to products and design for you the right solution.



Fire shutters in manufacture hall



Fire shutters - Airport Václav Havel - Prague



Fire shutter installed on conveyor belt



Fire shutter in garage



Application of FKK-ROLL mini



Fire shutter in theater